

Courses & distances down Ten Mile

C-171

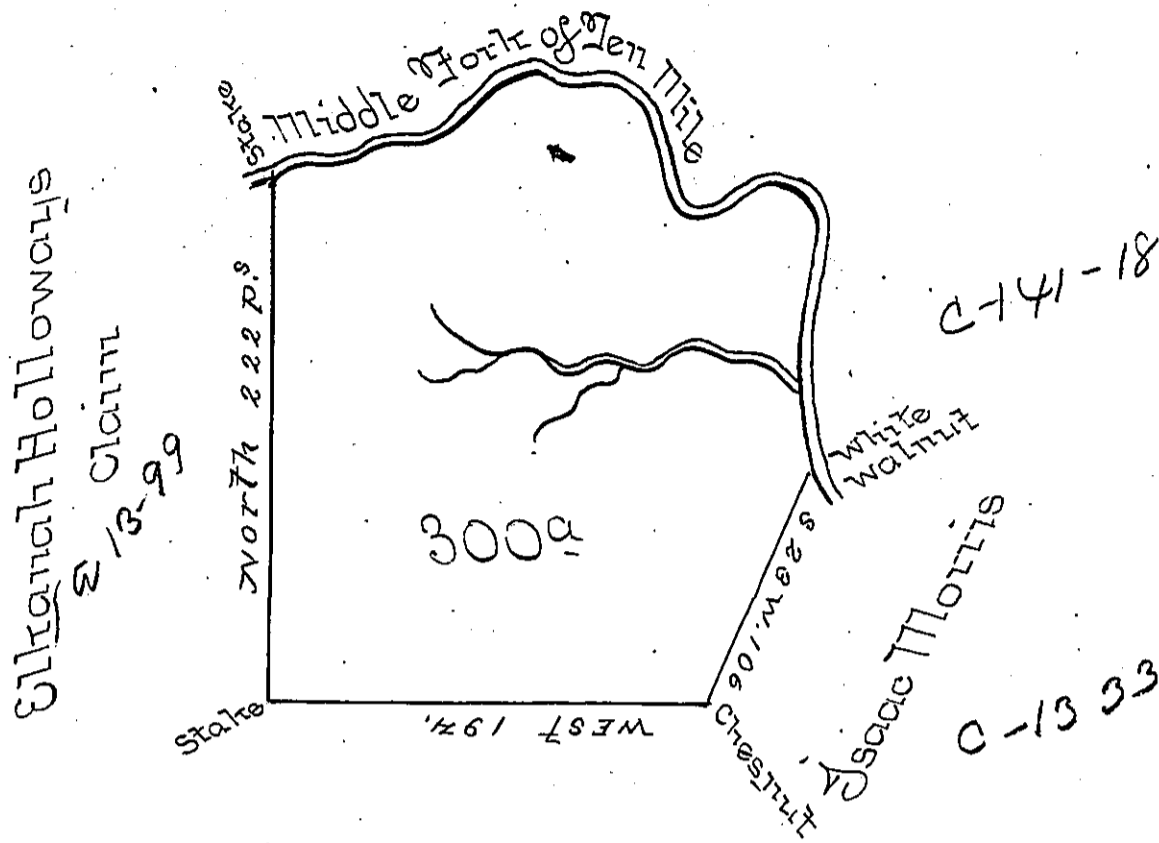

N. 75 E. 76	Perches
N. 60 E 28.	
N. 72 E 26.	
East	26.
S. 71 E 27	
S. 17 E. 18.	
S. 50 E. 18.	
N. 75 E. 77	
S. 37 E 16.	
S. 0277 100	
S. 17 E 17.	
<hr/>	
Total	389.

Noah Cooke's Claim

(Amwell top)

The above is a Draught of a Survey made May 13th 1787 in Pursuance of a Warrant granted to David Enoch Jun^r dated June 29th 1785. The Land is situated on the Middle Fork of Ten Mile Creek in Washington County &c - called Batchelors Hall containing Three hundred Acres with allowance of 6 per Cent.

John Lukens Esq^r S. Gen^l

David Redick D.S.

IN TESTIMONY that the above is a copy of the original remaining on file in the Department of Internal Affairs of Pennsylvania, made conformably to an Act of Assembly approved the 16th day of February, 1833, I have hereunto set my Hand and caused the Seal of said Department to be affixed at Harrisburg, this fifth day of April 1898.

James W. Latta
Secretary of Internal Affairs.